

Installation and Maintenance Instructions

1. ADIR Semi – Automatic Screen filters 2"- 3" **TS** Pg.2-3
2. ADIR Semi – Automatic Screen filters battery model **TSB**Pg. 4-5

ADIR Semi – Automatic Screen filters 2”- 3” TS

Installation and maintenance instructions

Assembly

- Check that the bushing is installed on the filter cup.
- Connect the 1” flush valve to the bushing. The bushing guarantees that the flushing pipe operates properly.
(No need to use Teflon, both valve and bushing are self-seal).

Installation

- Filter can be installed in vertical position or at 90° to the pipe, (Flush valve pointing down or to the side).
- Ensure proper flow direction as clearly marked on the filter.
- Make sure that flush valve is closed.
- It is recommended to install a shut off valve before the filter for maintenance.
- Filter is ready for first operation.

First Operation

- Open the water source gradually and check for leaks.
- Perform 2-3 flushing cycles as outlined below.
- Filter is ready for use.

Flushing the filter

- Filter must be flushed when the head loss across the filter reaches 0.5 Bar.
 - Pressure is measured by inserting a pressure gauge with needle into the pressure ports.
 - It is recommended to install a pressure indicator on the filter. The indicator enables quick and easy way to show the user that the filter is clogged and needs flushing.
 - When pressure loss across the filter element reaches the preset value of 0.5 bar, (7 psi), the red pin pops up and the user can see from a distance that the filter needs flushing.
After flushing the button descends into the indicator body.
 - When indicator is installed it should be connected directly to the pressure testing port located on the filter body at the inlet.
 - When a pressure indicator is installed there is no need to perform manual pressure tests.
- Open the flush valve gradually.
- Turn the scanning handle counterclockwise – it will move upwards, until it stops.
- Turn the handle clockwise – it will move downwards, until it stops.
- Close the flush valve gradually and check pressure.
 - In case a pressure indicator is installed the red pin should descend.
- In case the filter is still dirty (head loss is still high or the indicator pin did not descend, perform another flushing cycle).
- If the filter is still dirty user should perform a manual flushing.



Water flow to the field is uninterrupted during flushing.

Flushing the filter

- Close the inlet valve to the filter.
- Open flush valve gradually and drain filter.
- Open the filter locking ring and remove the cup.
- Remove the screen out of the filter and flush thoroughly (do not use a wire brush).
- After cleaning the screen assemble the filter.
 - Open the inlet valve gradually.
 - Filter is ready.

Warning:

Never open the filter cup under pressure.

| | |
|----|---------------------|
| 1 | Handle |
| 2 | Cover |
| 3 | Filter body |
| 4 | Flush Pipe |
| 5 | Locking Ring |
| 6 | Nozzle |
| 7 | Inox. Filter Screen |
| 8 | Cup |
| 9 | Bushing 1"F X1"M |
| 10 | 1" Flush Valve |

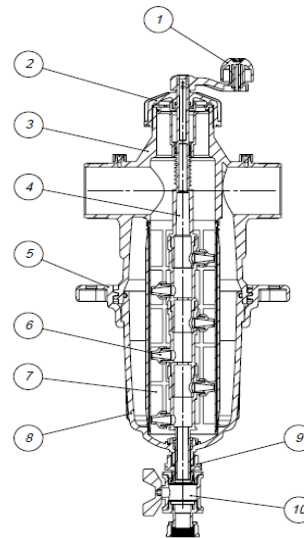

Technical specifications:

Available sizes: 2"; 3".

Filtration area: 950 cm²

Max working pressure: 10 Bar

Max. flow rate:

- 2" - 25 m³/h
- 3" - 45 m³/h

Available in 80 – 200 mesh.

Min. flushing pressure: 2 Bar

Flushing flow rate:

- 5.4 m³/h at 2 Bar
- 6.8 m³/h at 3 Bar

Construction materials:

Nylon, Polypropylene., Inox 316 screen, O ring - EPDM

| | 2" | 3" |
|---|-----|-----|
| A | 280 | 280 |
| B | 490 | 508 |
| C | 720 | 750 |

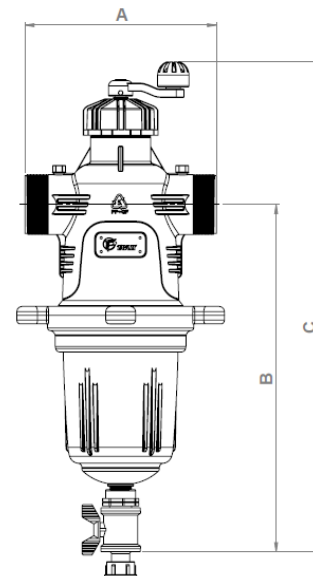

ADIR Semi – Automatic Screen filters battery model TSB

Installation and maintenance instructions

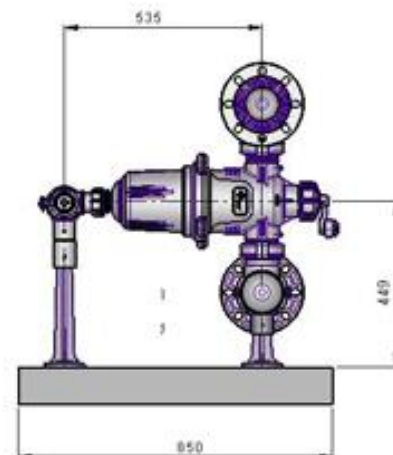
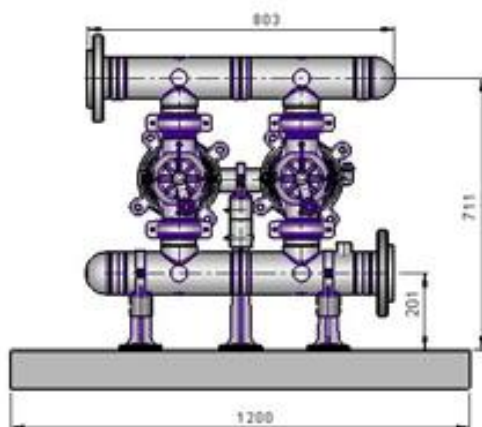
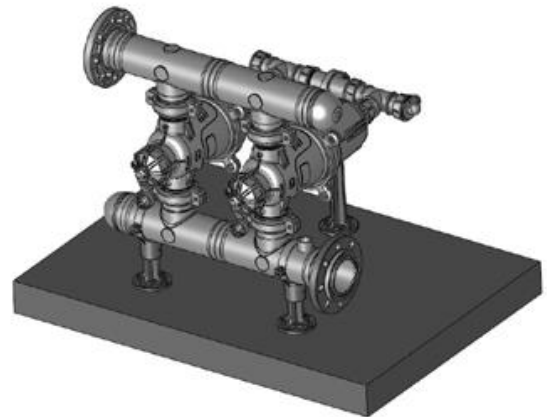
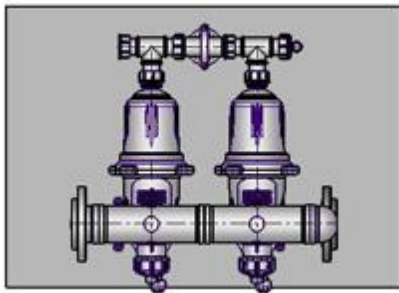

We recommend the following in order to guarantee the proper functioning of the filters:

- Pressure indicator, (supplied separately), should be connected to the designated ports.
 - Please pay attention to connect properly (indicator installed on the outlet manifold and the tube connected to the indicator.
- An air release valve should be installed at the inlet to our filtration system on the top elbow at the system inlet.
- A butterfly manual valve should be installed at the system inlet.
- Drainage manifold should be connected to a 50 or 63mm PE pipe in order to carry the flushed water out of the container.
 - Pipe should no longer than 5 meters.

Initial operation

- Make sure all filters drain valve is closed.
- Fill the battery gradually in order to prevent water hammer.
- Perform a flushing cycle of each filter one after the other.
- First open the drain valve located at the filter bottom.
- Rotate the handle all the way up until it cannot be rotated. Then rotate to the other direction
- Do not use power to rotate the handle.
 - Flushing cycle: 10 – 20 sec.
- After the flushing close the drain valve.
- After the flushing cycle the indicator should show that the battery is clean.

Operation

- When the indicator's red button pops up the user must perform a flushing cycle on all the filters in the battery.
 - Flushing is performed on each filter one after the other as described above.
 - Filter maintenance instructions are attached.
- It is recommended to initiate a flushing cycle once a day.

